

In the **Base Flange** PropertyManager under **Direction 1**, set the **End Condition** to **Blind** and the **Depth** to **.5**.

Under **Sheet Metal Gauges**, check the **Use gauge table** check box, and pick **CRS GAUGES** from the **Select Table** pull down.

Under **Sheet Metal Parameters**, pick **18 Gauge** for the **Thickness**, and make sure that the **Reverse direction** check box is not checked.

Under **Bend Allowance**, make sure that **K-Factor** is selected. The default value of **'0.3333'** should appear in the window below this. If not, check the **Override value** box and set the value to **'0.3333'**.



Click the green check mark button at the top of the **Base Flange** PropertyManager to accept the settings and create the part.

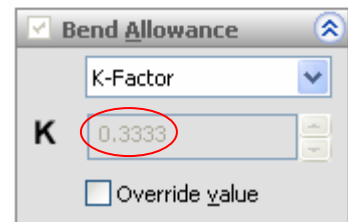
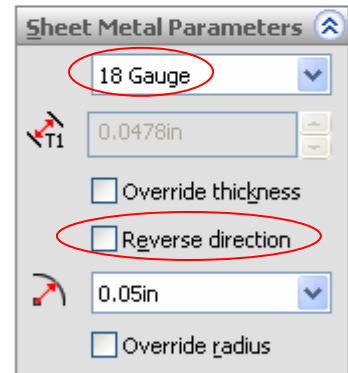
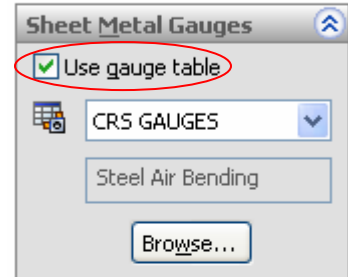
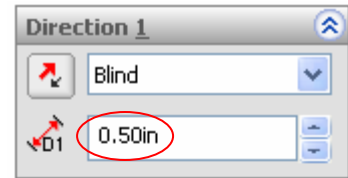

## Unfold the Clamp



To unfold the clamp, click the **Unfold** icon in the CommandManager, or pull down the “Insert” menu and pick **Sheet Metal – Unfold**.

For the **Fixed face**, select the edge of the cutout as shown.

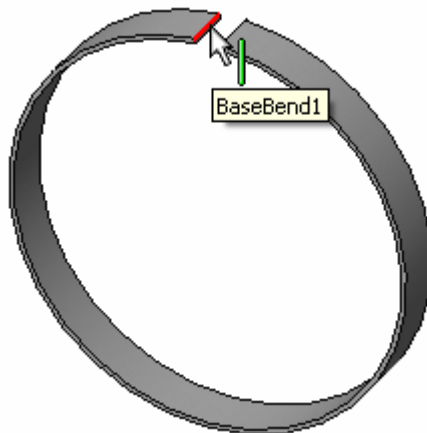

For the **Bends to unfold**, click the **Collect All Bends** button.



Click the green check mark button at the top of the **Unfold** PropertyManager and the bends will unfold.

In the bottom left corner of the graphics area, change the View orientation by clicking the pull down arrow and picking **Top**, or press **Ctrl+5**.

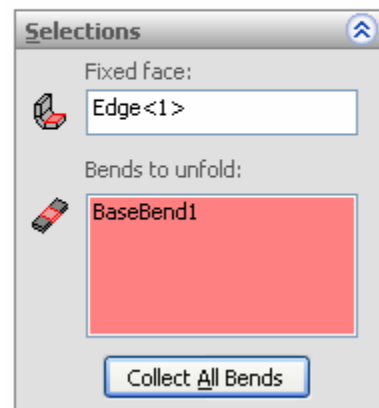

## Chamfer the Corners

Change back to the **Trimetric** view by clicking the View orientation pull down arrow in the bottom left corner of your graphics area and picking **Trimetric**.



Use the **Zoom to Area** command to zoom in on the right end of the part.

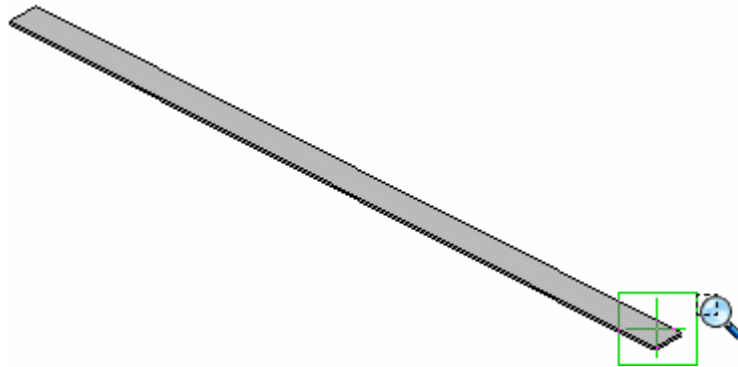

Click the **Features** icon in the control area of the CommandManager. Then, click the **Chamfer** icon from the toolbar, or pull down the “Insert” menu and pick **Features – Chamfer**.

Select the two vertical material thickness edge lines at the right end of the part.

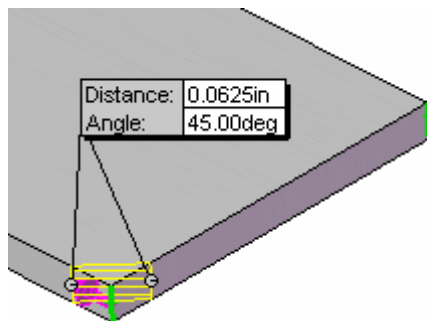

Set the **Distance** to ‘**0.0625**’ and make certain the **Angle** value is set to **45** degrees.



Click the green check mark button at the top of the **Chamfer** PropertyManager.

In the bottom left corner of the graphics area, change the View orientation by clicking the pull down arrow and picking **Top**, or press **Ctrl+5**.

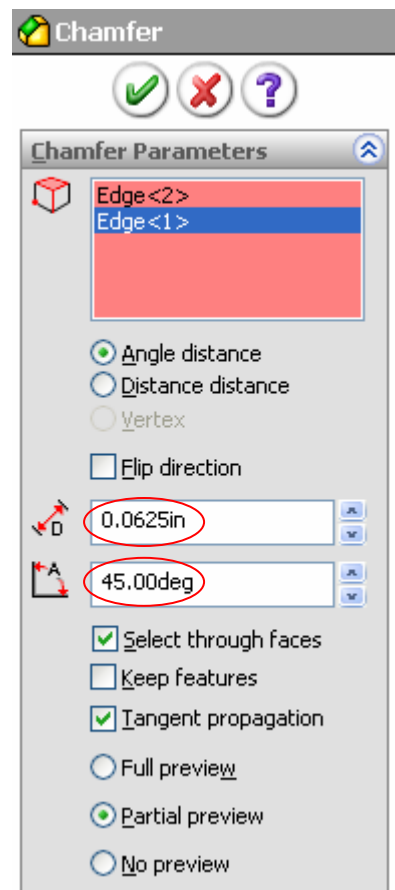

## Create a Cutout Pattern



Click the **Extruded Cut** icon from the CommandManager or pull down the “Insert” menu and pick **Cut – Extrude**.

Select the top of the part.

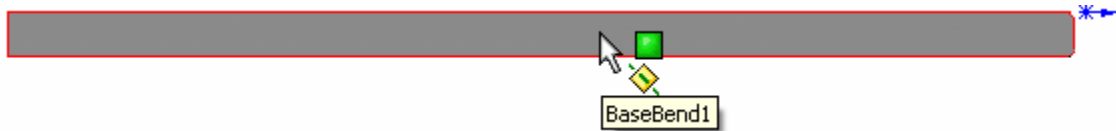

Create a horizontal centerline line through the midpoint of the right vertical edge using the **Centerline** icon in the CommandManager, or pull down the “Tools” menu and pick **Sketch Entities – Centerline**.



Create two vertical lines on the far right of the part as shown using the **Line** icon in the CommandManager, or pull down the “Tools” menu and pick **Sketch Entities – Line**.



Press the **Escape** key and then hold down the **Ctrl** key and select both of these lines. In the **Properties** PropertyManager, click on the **Equal** button.

Right click on the right vertical line and pick **Select Midpoint** from the menu. Then, hold down the **Ctrl** key and select the centerline.



In the **Properties** PropertyManager, click on the **Coincident** button.

Repeat this for the left vertical line.



Click on the **Tangent Arc** icon in the CommandManager, or pull down the “Tools” menu and pick **Sketch Entities – Tangent Arc**.

Connect the top and bottom of the vertical lines using tangent arcs. You may need to zoom in closer to see the endpoints needed to create the arcs.

